



11 Dane Road, Luton, Beds, LU3 1JW

An immaculately presented two bedroom mid terrace home located on the ever popular Dane Road, offering spacious and modern living throughout. This charming property features two generously sized double bedrooms, two bright and versatile reception rooms, a modern kitchen and bathroom, and a rear yard. Ideally situated close to a range of local amenities including shops, well regarded schools, and places of worship such as nearby mosques, this home is perfect for first time buyers, small families, or investors alike. With excellent transport links and a move in ready finish, early viewing is highly recommended. Call Nova Estate Agents now to arrange a time.

- Nova Estate Agents
- Press Play Button For 360° Walkaround Tour
- 2 Bedroom Terraced House
- Good Condition Throughout
- Chain Free
- 2 Reception Rooms
- Close to Local Amenities

£240,000

Approx Gross Internal Area
66 sq m / 709 sq ft

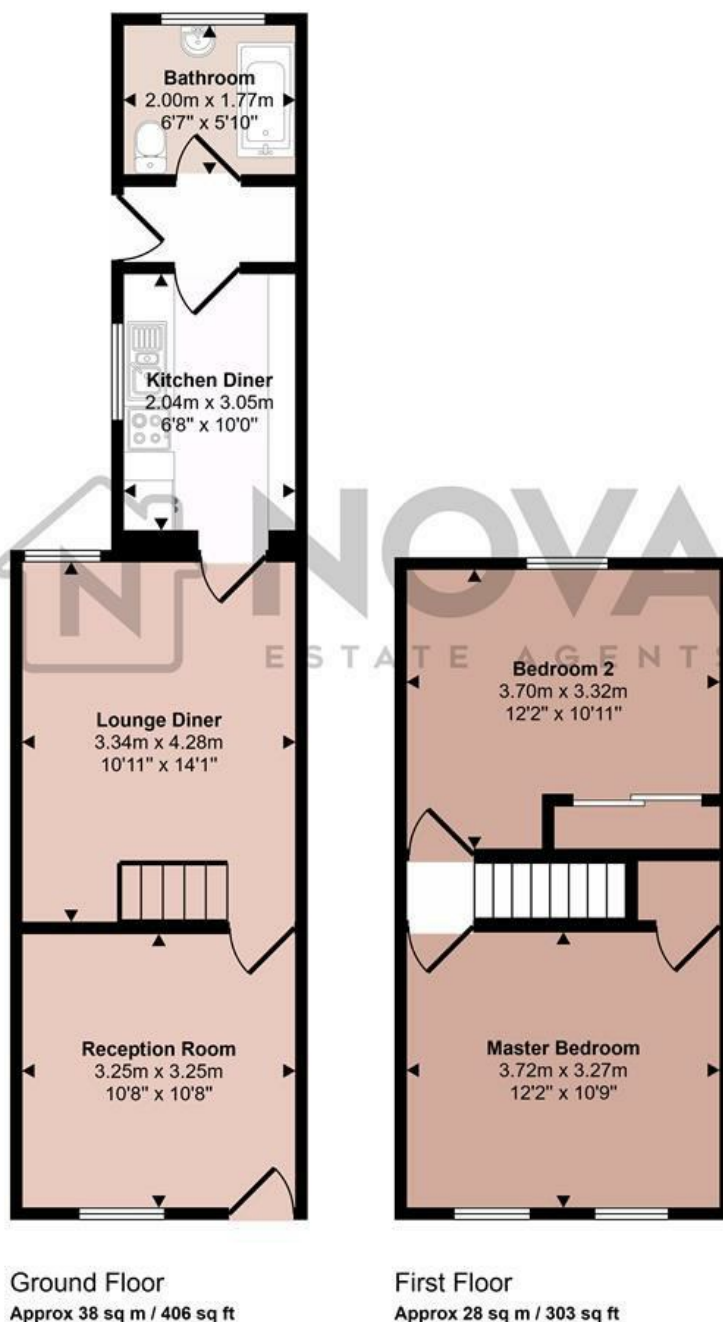

This floorplan is only for illustrative purposes and is not to scale. Measurements of rooms, doors, windows, and any items are approximate and no responsibility is taken for any error, omission or mis-statement. Icons of items such as bathroom suites are representations only and may not look like the real items. Made with Made Snappy 360.

